

STAT-O-GIDE™

Anti-Static Press-In Card Guides

- Static Dissipative. Surface Resistivity of $10^5 - 10^9$ ohms/square (ASTM D257)
- Narrow width (*less than 1/4"*) allows maximum density and optimum air flow

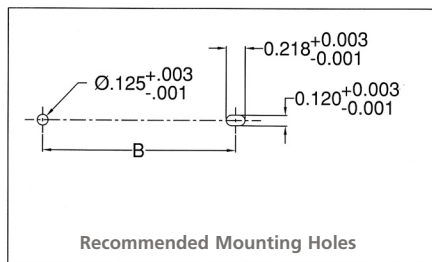
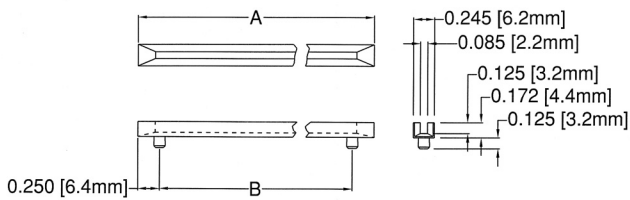

STAT-O-GIDES™ Precision molded to tight tolerances from static dissipative material as defined by the Department of Defense Handbook 263 (DOD-HDBK-263), these guides are specifically designed to prevent ESD in applications requiring protection for static-sensitive devices.

Mounting Information:

Press-in metal plates: 0.048" / 0.085" (1.2) / (2.2) thick. U.S. sheet metal gauges 18/14
 Hole size: Front - 0.125 (3.2) dia. + 0.003 (0.08) - 0.001 (0.3),
 Rear - 0.218" (5.5) x 0.120" (3.0) + 0.003 (0.08) - 0.001 (0.3)

Material Specifications:

6/6 Nylon with permanently bound-in electrical grade PAN fibers which prevent sluffing or transfer of conductive material. Gray in color. Static decay performance meets or exceeds both NFPA and MIL-B-81705B requirements.

Oxygen Rating Index:

Over 28%

Standard Drawing Tolerances:

(unless otherwise indicated)

Fractions: $\pm 1/64$ (.40) .XX = $\pm .010$ (.254)

.X = $\pm 1/64$ (.40) .XXX = $\pm .005$ (.127)

Note:

Slotting or elongating of 2nd mounting holes is recommended to allow for length variations in molding and assembly ease.

Stat-O-Gide

2-1/2" thru 8-1/2" Lengths
 Color: Gray

Part No.	A	B
	$\pm .030$ (.76)	$\pm .024$ (.61)
S-250	2.538 (63.5)	2.030 (51.6)
S-300	3.045 (76.2)	2.538 (64.5)
S-350	3.553 (88.9)	3.045 (77.3)
S-400	4.060 (101.6)	3.553 (90.2)
S-450	4.568 (114.3)	4.060 (103.1)
S-500	5.075 (127.0)	4.568 (116.0)
S-550	5.583 (139.7)	5.075 (128.9)
S-600	6.090 (152.4)	5.583 (141.8)
S-650	6.598 (165.1)	6.090 (154.7)
S-700	7.105 (180.5)	6.598 (167.6)
S-750	7.613 (193.4)	7.105 (180.5)
S-800	8.120 (206.2)	7.613 (193.4)
S-850	8.628 (219.2)	8.120 (206.2)